

# Monticello Column Set-Up Instructions

U.S. Patent  
#5,439,043

1

Magnets  
on ends

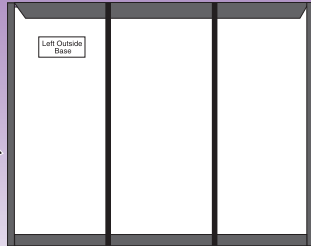

Start with the flat, flexible panel...

2

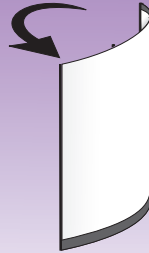

Roll the flat flexible panel  
into a column shape...

3

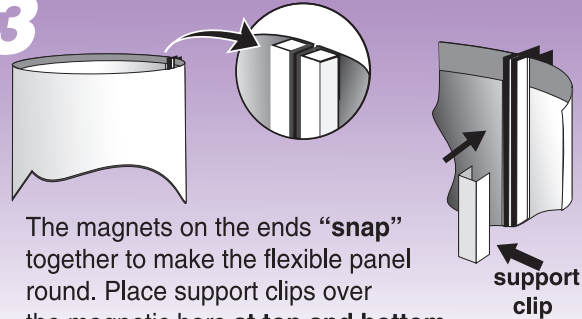

The magnets on the ends “**snap**”  
together to make the flexible panel  
round. Place support clips over  
the magnetic bars **at top and bottom**,  
to lock them together.

4

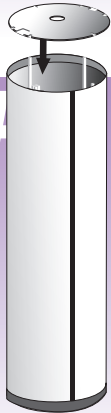

Next, the  
hubs are  
placed into  
both ends of  
the Column  
to keep it  
round...

5

Now, the bottom column  
is ready to be  
**Snapped** Magnetically  
to the unit...  
NOTE: some columns  
may **slide onto** the  
panels with a  
**U-channel**.

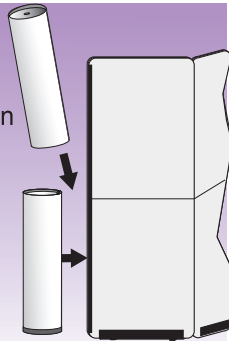

6

Next, place the top column piece  
onto the bottom piece, guiding  
the **square pins** into the  
**square channels** to hold it in  
place and keep the magnet  
strips (or U channel) aligned.

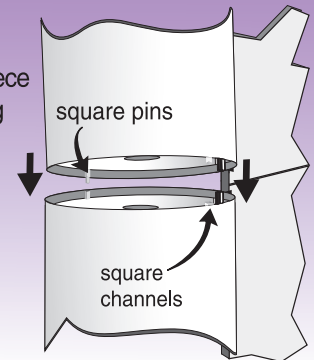

Visit [Expogo.com](http://Expogo.com)

**Expogo!**  
ExpoStar®-Prezenta®-ArchiForm®

(800)-891-1869