

10' Monticello with Backlit Header

U.S. Patent
#5,611,384

Assemble column sections first

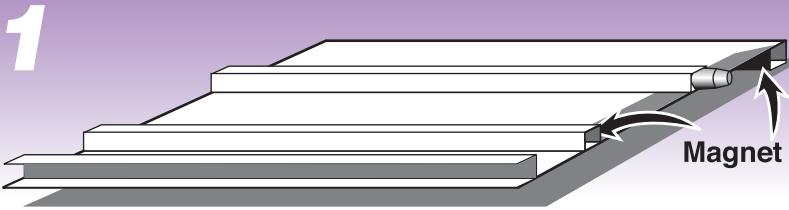

Place curve on flat surface, fabric side down, facing large "U" channel.

2 Roll far edge of panel forward, creating a tube shape. Align aluminum bars with magnets and allow bars to "snap" together to complete curved shape.

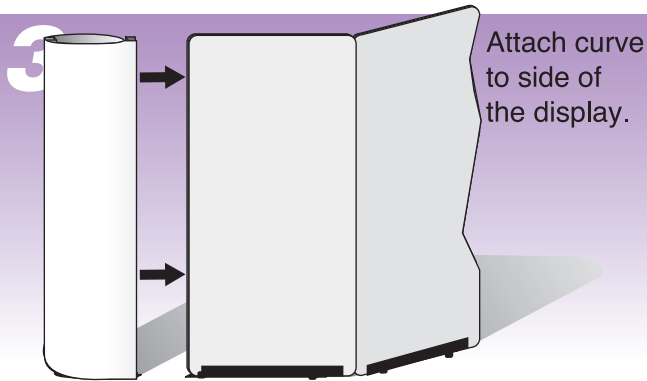
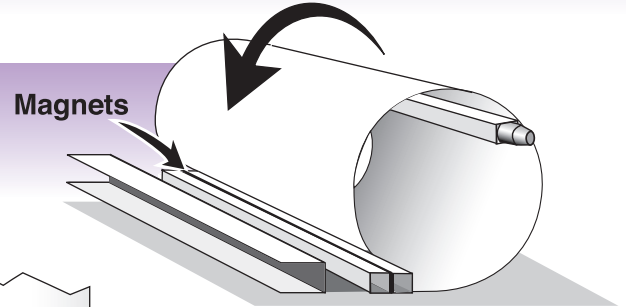

Attach curve to side of the display.

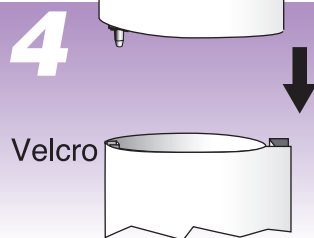

4 To stack curves on a freestanding display, line up metal pin with metal tubed slot on lower half and guide into place. U-channel on column slides onto fabric panel edge.

Display Assembly

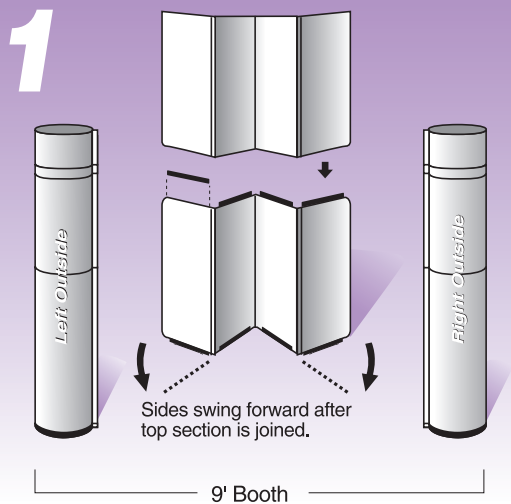

Sides swing forward after top section is joined.

9' Booth

Begin set-up of center section with **Four Panel Base** between and slightly behind columns.

Insert stacking guides in all sections of base panel.

With center section "accordion" folded, **lower upper section onto base.** (Shown slightly unfolded in diagram for clarity)

Next, swing sides forward toward columns.

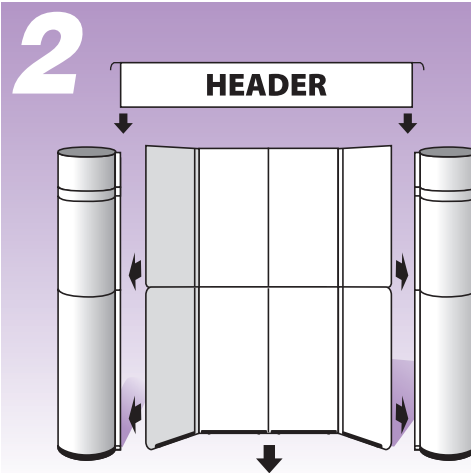

Push center hinge forward to make center of display area flat.

Slide entire center section forward and snap the magnets onto the magnetic strips on the columns or insert the side panels' edges into "U" channels on columns.

2 Piece Header Assembly (below)

Align the two pieces of header frame so the metal pins insert into the aluminum channel, hook the latch onto the opposite side and snap it closed.

Rear view

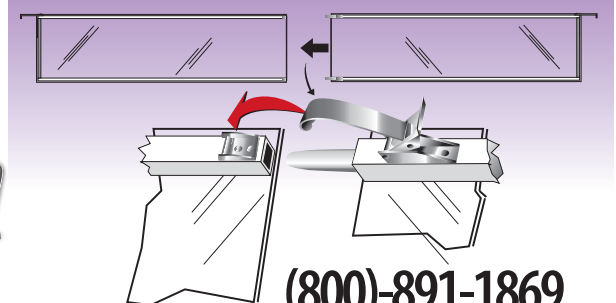

Visit Expogo.com

EXPOGO!
Displays & Graphics

(800)-891-1869